

Peacock

STAINLESS STEEL HANDY POT USER INSTRUCTION MANUAL

AHR MODEL

Thank you for purchasing our product. Before using please read this manual carefully to ensure the best possible performance. Please store your instruction manual in a safe place for future reference.

PARTS

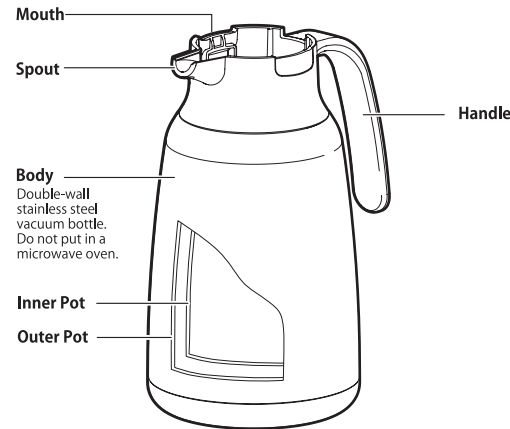
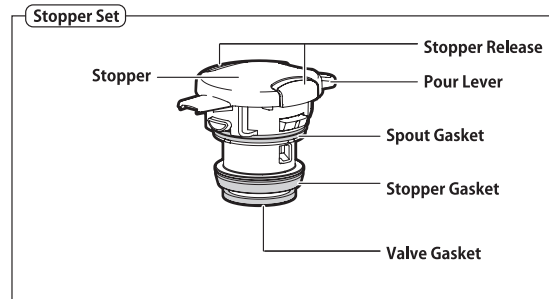

Actual product may vary from illustration in this manual.

HOW TO CLEAN

- ◆ Always clean the product on the same day it was used.
- ◆ Always use a soft sponge for cleaning.
- ◆ Clean frequently to prevent unpleasant odors.

Outer Pot / Stopper set

Soak a sponge in water or lukewarm water with neutral kitchen detergent, wash and rinse thoroughly. After that, wipe off any moisture with dry cloth. *Do not presoak.

Inner Pot

Soak a long handle sponge brush, etc. in water or warm lukewarm with neutral kitchen detergent, wash and rinse thoroughly, and air dry to remove any moisture. *Do not presoak.

Gaskets

Remove from the stopper. Soak a sponge in water or lukewarm water with neutral kitchen detergent, wash and rinse thoroughly. After that, wipe off any moisture with dry cloth. Follow the instructions on ("HOW TO INSTALL GASKETS") to securely install it to the stopper (any foreign object left on the gasket surface can cause the product to leak).

WHEN CLEANING

Read the below instructions carefully before cleaning the product, and make sure to follow them.

- **Do not use chlorine bleach.** It may cause rusting, pinholes, and other damage.
- **Do not use bleach on the outer pot.** There is a risk of rusting and coating damage.
- **Remove the stopper set when using oxygen bleach for the inner pot.** It causes a rise in pressure inside the body, which is dangerous (e.g., stopper set may pop off).
- **Do not use thinner, benzene, wire sponges, scrubbing brushes, polishing powder, abrasive cleaners, chemical rags, or other non-kitchen detergents.** It causes scratches, rusting, and other damage.
- **Do not boil the body or stopper set, or use a dishwasher, dish dryer, etc. to clean or dry them.** It causes scratches, rusting, deformation, leaks, and other damage.
- **Do not soak or submerge the container in water for cleaning.**
- **When not using the product for extended periods of time, clean it carefully to remove any dirt, let it dry thoroughly, and store it away from high temperatures and humidity.**

AFTER PARTS SERVICE

We will keep the consumable parts mentioned in this manual for 5 years after the model has been discontinued for production. For any other product-related inquiries, please contact the store where you purchased the product or your local Peacock Distributor.

CONSUMABLE PARTS

Part name
AHR TYPE Stopper Set (Spout Gasket, Stopper Gasket, Valve Gasket)

*See "PARTS" to cross-reference consumable parts and their names.

HOW TO REMOVE RUST SPOTS AND WATER STAINS

Depending on the water quality and the presence of impurities, it may lead to the development of rust spots or water stains on the inner pot. To remove them, follow the instructions below.

- ① **Pour boiling water into the product, up to prescribed amount, and add approximately 10 g of citric acid.**
- ② **After about three hours, wash the inner pot with a long handled sponge brush, and rinse thoroughly with clean water.**
- ③ **Wipe off the moisture on the product and air dry thoroughly.**
 - To prevent unpleasant odors and maintain hygiene, clean the product thoroughly before and after use.
 - When cleaning the product together with other items, be careful not to damage the product.

BEFORE CONTACTING US

Please check your product before you contact our service center. If none of the items described below applies to you, please contact the store where you purchased the product or our local distributor.

SYMPTOM	POINTS TO CHECK	ACTION
Content leaks from stopper	Please check if the gaskets are properly and securely installed.	Make sure that each gasket is securely in place and installed in the correct position and direction.
	Please check if the stopper set are properly and securely installed.	Install correctly.
	Please check if the gaskets are clean with no foreign objects.	Clean the gaskets by following the instructions in "HOW TO CLEAN".
	Please check if there is too much beverage in the product.	Adjust the beverage amount down to prescribed amount.
	To maintain the performance of the pot, there is an air vent on the stopper set. Please note that even if you tilt the pot without pressing the pour lever, some drink may leak from the spout.	
Beverage (inner pot or stopper) has unpleasant odor	Was the beverage left in the product for a long period of time? Are there tea stains or any other stains on the inner pot, stopper set, or gaskets?	Clean the product by following the instructions in "HOW TO CLEAN". If the stains are difficult to remove, use citric acid.
Product does not keep the beverage inside warm or cold	Was the beverage sufficiently hot (cold) when it was put in the product?	Fill the product up to prescribed amount with a sufficient hot (cold) beverage.

*The stopper gasket, and stopper set are consumable parts. Please check every 6 months to 1 year for damage or deterioration.



THE PEACOCK VACUUM BOTTLE CO.,LTD.

5-12-20, Sagisu, Fukushima-ku, Osaka, 553-0002, Japan
E-mail: peacockinquiry@the-peacock.co.jp

SAFETY PRECAUTIONS

Use only for thermal retention of beverages

Never put in product

- **Dry ice, carbonated beverages, etc.**

Pressure inside the body will increase, causing the stopper set to become difficult to remove, the beverage to spurt out, or parts to break and possibly cause injury and other incidents.

- **Soups and other salty content.**

Cause of rusting and decline in thermal retention performance.

- **Milk, milk-based beverages, fruit juice, etc.**

Cause of decay, deterioration, and rusting. If the beverage is left inside the product over a long period, decay and deterioration can lead to gas emission, which increases pressure inside the body. This can cause the beverage to spurt out or parts to break, possibly resulting in injury and other incidents.

- **Fruit pulp, tea leaves, etc.** Cause of leaks and other damage.

- **Keep the product out of reach of infants and small children and ensure that it is not played or tampered with.**

There is a risk of scalding and injuries.

- **Keep away from fire (heaters, stoves, etc.).**

It may cause deformation and discoloration.

- **Do not carry the product in a car or any other vehicle.**

Risk of burns.

- **When pouring a beverage into the product, fill the product only up to prescribed amount.**

Exceeding the maximum can cause leaks, overflow, and scalding

- **When carrying, hold it by the handles. Do not tilt or carry it sideways, as this may result in spills, burns or stains.**

- **Do not carry the product by holding the stopper set or the pour lever, as it could be dangerous if dropped.**

- **Do not carry the product with the pour lever pressed down, as this may cause leakage or burns.**

- **Do not knock over, drop, hit, or apply strong impact to the product.**

It can cause breakage, decline in thermal retention performance, rusting, coating damage, and content leakage.

- **Use the product with its stopper set securely closed.**

Risk of leaks, scalding, and other incidents.

- **Do not roll the product when it is filled with liquid, as leakage could occur.**

- **Do not press the pour lever while the product is tilted or near the face.**

Liquid or steam may come too quickly, leading to burns.

- **When using the product with a hot beverage inside, tilt the product slowly to pour the beverage.**

- **Do not cover your head or office with the plastic product bag, as there is a risk of suffocation.**

- **Do not modify or disassemble and repair the product.** Cause of breakage and accidents.

- **Do not place this product on a flame, in a microwave, or on an induction cooker (IH).**

Doing so may cause burns, damage, or malfunction.

- **When adding ice, pour the drink first, then tilt the container and carefully slide in small crushed ice pieces.**

- **If the product is filled with a beverage, clean it immediately after use.**

- **Do not leave beverages inside the product over a long period.**

Cause of decay and deterioration.

- **Keep hot kettles from touching the mouth of the pot.**

The product may be knocked over, causing scalding, etc., or be damaged or deformed.

- **When using the product with a hot beverage inside, tilt the product slowly to pour the beverage.**

Tilting it abruptly can cause the beverage to gush out, possibly resulting in scalding and other incidents.

Do not use the product if you hear the sound of water from inside its vacuum layer.

Thermal retention performance may have declined. Also, water accumulated in the vacuum layer can seep into the inner pot, and drinking this water can cause health problems.

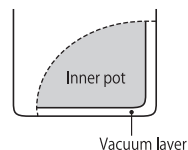

HOW TO INSTALL GASKETS

Improper installation can cause content to leak from the product.

If the stopper gasket has been removed for cleaning or any other reason, read the instructions below to properly install it back in place.

How to install the Spout Gasket

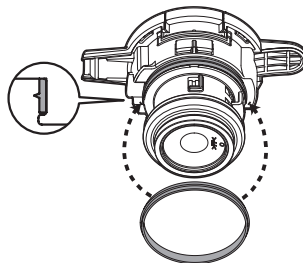

Fit the gasket into the center groove of the inner stopper, paying attention to the front and back.
※There is no difference between the top and bottom of the components.

How to install the Stopper Gasket

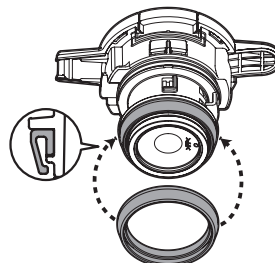

Fit the gasket into the lower groove of the inner stopper, paying attention to the top and bottom.

How to install the Valve Gasket

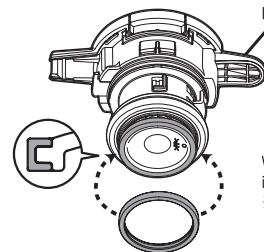

Hold down the pour lever.

While holding down the pour lever, insert the valve gasket firmly into the valve of the inner stopper.
※There is no difference between the top and bottom of the components.

INSTRUCTIONS

Before using the product for the first time, wash the stopper set and body.

① Remove the stopper set

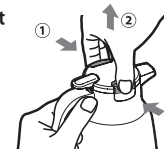

- ① Hold the handle with one hand and pinch the stopper release.
- ② Pull the stopper set out from the pot.

② Pour the beverage into the product

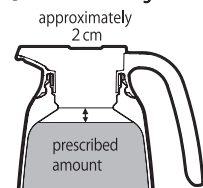

For better retention results, leave a small amount of hot or cold water in the product for about one minute in advance to preheat or precool the product. When pouring a beverage into the product, fill the product to no more than prescribed amount shown in the figure.

Closing the stopper set with too much beverage inside can cause the beverage to spurt out, or to leak out afterwards. If the product has been filled with too much of the beverage, adjust the amount down to prescribed amount before dosing the stopper set.

③ Close the stopper set

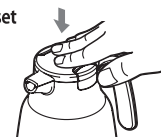

Align the pour lever with the handle, and press firmly until the tabs on both sides of the stopper release click into place.

④ Pour the drink into the cup

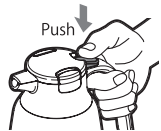

- ① Press the pour lever while keeping the main body upright.
- ② Slowly tilt the main body to pour while holding the stopper release down.

⑤ After Pouring

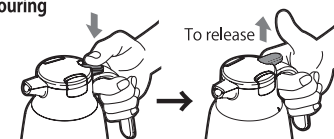

- ① Return the main body upright while holding the pour lever.
- ② Release the pour lever after 2 to 3 seconds.

[Caution]

Do not release the pour lever while the main body is tilted.

There is a risk that liquid will remain in the inner stopper set and leak out when carried.



Pour Lever

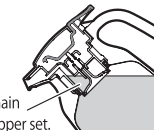
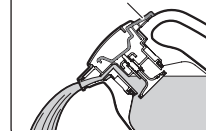

Liquid may remain in the inner stopper set.