

SAFETY PRECAUTIONS

- Do not allow the hot kettles to touch the mouth of the bottle. (The bottle may tip over and cause injuries or damage to the bottle.)
- Avoid dropping, hitting or strong shock against the bottle. (It may damage the plastic or stainless steel surface of the bottle and reduce its ability of heat or cold retention.)
- Do not force large ice cubes into the bottle. Forcing or hitting the ice cubes may cause deformation or malfunction of the bottle.
- Do not place near heat sources such as gas stoves, ovens and heaters.
- Do not shake the bottle after pouring hot beverages into the bottle. The pressure inside the bottle will increase and the stopper may become difficult to remove.
- Please be cautious while drinking with the mug. Due to the vacuum insulation, the outside of the mug will not become hot while the beverages remain very hot for many hours.
- Please make sure the bottle is put upright when stored in a carrying bag to prevent the beverages from spilling.
- The bottle may not be able to fit into the cup holder for certain model of cars.
- Hot tea may discolor if kept in the bottle for a long period of time. It is recommended to use tea bags during the outdoor use.
- Do not soak the bottle when cleaning it.
- After cleaning the bottle, wipe off the water on the bottle thoroughly. (There will be water stains or rust spots if not wiped off thoroughly.)
- Wipe off the stopper and spout after cleaning.
- Do not clean with thinner, benzene, abrasive cleaners or other harsh cleaners. (To avoid damaging the bottle.)
- Do not use chlorine bleach. (It may cause rust on the inner surface of the bottle.)
- Do not boil the bottle or use dishwasher or dish-dryer to clean and dry the bottle. (It may cause rust, deformation or damage to the bottle.)

TO REMOVE RUST SPOTS AND WATER STAINS

You may find rust spots or water stains caused by the impurities in your drinking water. To remove these, fill the bottle with hot water and then add 10% vinegar in it. Put the bottle aside for about 3 hours. After that, wash the interior of the bottle thoroughly with a soft sponge.

- To prevent the unpleasant odor, please clean the bottle thoroughly before and after use.
- Please make sure you clean the bottle with a **soft** sponge to protect the surface of inner bottle from being scratched.

BEFORE CONTACT OUR SERVICE CENTER

Please check your bottle before you contact our service center. Please contact our service center, if what you encountered is not described below.

| SYMPTOM | CHECK POINT | WAYS TO HANDLE WITH |
|-----------------------------------|---|--|
| Water leaks from the lid | Make sure the stopper gasket is placed properly on the lid. | Please refer to the how to install the gasket section in this manual. |
| | Make sure the drinking cap set is placed properly on the bottle. | Install the drinking cap properly. |
| | Is there any dirt on the stopper gasket? | Please refer to the "how to clean section" in this manual. |
| Bad odor from inner bottle or lid | Did you fill too much water in the bottle? | Please pour out some beverage from the bottle. |
| | Check if there is any beverage stain on the inner wall of the bottle or on the gaskets? | Please refer to the how to clean section in this manual to clean the bottle thoroughly. Use vinegar to clean the bottle if the dirt is hard to remove. |
| Bad hot (cold) retention | Make sure the beverage is hot (or cold) enough in the bottle. | Please pour proper amount of hot (or cold) beverage in the bottle. |

※ Stopper, stopper gasket and drinking cap set are consumable parts. Please check once every 6 months to 1 year for damage or deterioration.

ABOUT PARTS FOR AFTER SERVICE

We will keep the consumable parts mentioned in this manual for 5 years after we discontinued the production of this model. If you have any questions regarding to our products, please contact the store where you purchase the product or call our Peacock Customer Service Center.

CONSUMABLE PARTS

| AMM TYPE | Parts |
|----------|--|
| AMG TYPE | Stopper gasket |
| AMC TYPE | Lid set (Stopper, Stopper gasket) |
| | Inner cap |
| | Mouth gasket |
| | Drinking cap (Inner cap, Mouth gasket) |

Peacock

STAINLESS STEEL BOTTLE MUG TYPE

**AMM • AMG
AMC • AKA**

USER INSTRUCTION MANUAL

Thank you for purchasing our product. Before using this unit, please read the instruction carefully to ensure the best possible performance.

PARTS

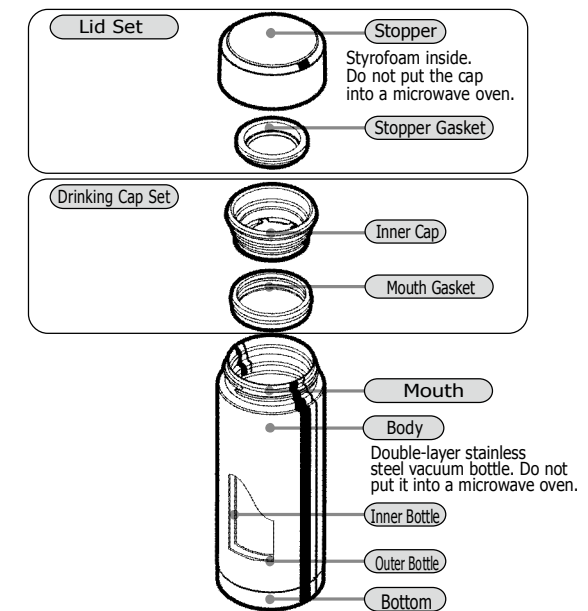

Actual products may vary from the product illustrated.

Please store your instruction manual in a safe place for future reference.

INSTRUCTIONS

1 Remove the lid set and drinking cap set from the bottle

- Remove the lid set by turning the lid anti-clockwise.
 - Detach the drinking cap set by turning the cap upwardly.
- ※ It will be easier to detach the cap by turning it upwardly.

2 Fill the bottle with hot (cold) beverage

- To increase the heat (or cold) retention, pour hot (or cold) water into the bottle and preheat (or precool) the bottle for about 1 minute.
 - Please refer to the right drawing for the maximum level of the beverage.
- The beverage may overflow if too much beverage is filled in the bottle.
- Please pour out some beverage from the bottle if the beverage above the maximum level.

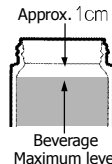

3 Close the lid set tightly

- Install the drinking cap on the bottle.
 - Turn the lid set clockwise to close the bottle.
- Please make sure the drinking cap is set properly.
 - Make sure the lid is closed.

4 Enjoy your beverage

- Remove the lid with the bottle stand upright.
 - Tilt the bottle and enjoy your beverage with the drinking cap.
- Tilt the product slowly when pouring hot beverage. (Due to the vacuum insulation, the outside of the bottle will not become hot. Please use with caution when drinking.)



Please clean the inner bottle, drinking cap set, lid set thoroughly before use.

5 Close the lid tightly after enjoying your beverage

- Put the bottle upright and then close the lid clockwise.

HOW TO TAKE CARE OF YOUR MUG

Please remember to clean your mug after every use.

Outer bottle, lid set, drinking cap set

Please wash the outer bottle, lid set and drinking cap set with warm water and then wipe dry with dry cloth. ※ Please remove the lid set and drinking cap set before washing.

Inner bottle

Please use a soft sponge with handle to wash the inner bottle thoroughly. It will keep your bottle clean and prevent unpleasant odors.

Gasket

It may cause water leakage if there is a foreign object on the gasket. Remove the gaskets from the lid or drinking cap. Wash with warm water and then wipe the gasket with dry cloth. After that, refer to the "How to install the gasket" section to reinstall the gasket correctly.

HOW TO INSTALL THE GASKET

The bottle will leak if the gaskets are not properly installed.

Please read below contents carefully to reinstall the stopper gasket and mouth gasket after you clean the bottle every time.

Stopper gasket

Install the stopper gasket on the lid. (Please notice the direction of the gasket when installing.)

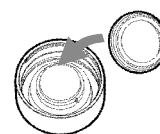

HOW TO INSTALL THE GASKET

Continued

Mouth Gasket

To Remove
Use finger to pull the mouth gasket gently.

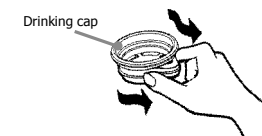

To Attach
Ensure the mouth gasket is set properly on the grooves of the inner cap.

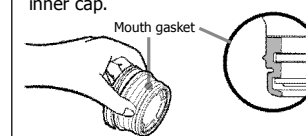

WHEN NOT USE THE BOTTLE FOR A LONG TIME

Make sure to clean the beverage stains on the bottle thoroughly before storage. Wipe the bottle with a dry cloth and allow all the parts to air dry.

IMPORTANT SAFEGUARDS

Do not use this product for any purpose other than keeping beverages warm or cold.

- Keep out of reach of infants and small children. (There is a risk of scalding or injuries.)
- Do not place the product near gas stoves, ovens or heaters. (To prevent deformation or discoloration.)
- Please make sure the stopper gasket and mouth gasket are set properly before using the product. (It may cause injuries or burns, or stain the interior of the car or clothes.)
- Do not carry this product around in a tilted position.
- Be careful not to scald yourself when using the product. Due to the vacuum insulation, the outside of the product will not become hot, while beverages inside remain very hot.
- Do not heat in a microwave. (It may cause sparks or deform or discolor the product.)

SAFETY PRECAUTIONS

Continued

- Please make sure the drinking cap is tightly set and the lid set is closed to prevent beverages from spilling. (Hot beverages may leak and cause scalding.)
- Do not disassemble or attempt to repair this product by yourself.
- This product should not be filled with any of the following items:
 - Dry ice or beverages containing carbon dioxide
 The pressure inside the product will increase, causing the lid set hard to open or the beverage to spout out and possibly cause injuries.
- Miso soup or other beverages containing salt
- The salt will stick to the sides of the inner bottle and cause rust.
- Milk based beverages or fruit beverages
- Prolonged storage may spoil the beverages. This will increase the pressure inside the product and cause the beverage to spout out and possibly cause injuries.
- Fruit pulp, tea or other kinds of leaves
- These may cause water leakage and possible malfunctions.
- Do not place the product with computer, mobile, digital camera and other electronic gadgets. (To avoid water leakage and damage the gadgets.)
- Do not use the product while driving. To prevent scalds or stain the interior of the car or clothes. Attempting to use the bottle while driving may distract the driver and may lead to serious accidents.
- When using a car cup holder
 - Make sure the cup holder is strong enough to hold the bottle before using. If the cup holder does not hold up, it may cause injuries or burns, or stain the interior of the car or clothes.
 - Do not use the hanging-type cup holder that attaches to the window or air vent. The cup holder may fall off.